

EV Charging Instructions for the CarShare Parking Space on the TRU Campus (FLO Chargers) – TESLA



Everything is located in the **center console**: AddEnergie card, Adapter, Log book, Vehicle Pre-Inspection book

CHARGE

1

Activate the station



Tap the AddEnergie card on the reader screen on the FLO car charger.

Hold card on screen until you hear 'beep'.

2

Open the door

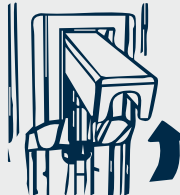

Open the station's door and pull out the connector.

The station's door may stick sometimes, please jiggle it.

3

Plug the connector

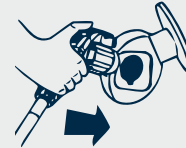

The charge port is on the driver side under the back light. Open by pushing on it.

Use the adapter that is in the center console. First attach it to the charger, then plug it into the vehicle.



Charging will start, and the light will change from blue to green.

DISCONNECT

4

Disconnect



1. Unplug the connector and adapter from the charge port.
2. Then push button on top of connector to release the adapter (see photo).
3. Return the plug adapter to the center console.

5

Complete charging

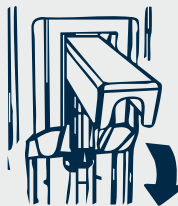

Once charging is complete, unplug the connector, replace it in its socket and close the door.

Remember to remove Tesla adapter and return it to center console.